



FIRST ANNOUNCEMENT
www.10mrc.com

10th MALAYSIAN ROAD CONFERENCE & EXHIBITION 2018 AND PIARC INTERNATIONAL SEMINAR ON ASSET MANAGEMENT

"Global Approaches to Advance Road Asset Management"

**29-31 October 2018 | Sunway Pyramid Convention Centre
Petaling Jaya**

- 20 CPD hours from Board of Engineers, Malaysia
- Road Engineering Excellence Award 2018
- Invention and Innovative Exhibition
- Outstanding Paper Awards

Jointly organised by:



Ministry of Works,
Malaysia



Public Works
Department,
Malaysia



Malaysian
Highway
Authority



Road Engineering
Association
of Malaysia



Construction Industry
Development Board
Malaysia



International
Road
Federation



Road Engineering
Association
of Asia & Australasia

In collaboration with:

CONFERENCE background

The biennial Malaysian Road Conference (MRC) held since 1994 has emerged as the premier national and regional platform for presenting research findings, discussing and exchanging ideas on cutting-edge technologies relating to the development, construction, management and maintenance of roads, highways and related infrastructure. The MRC is a much sought after event for those involved in the finance, design, construction, management and maintenance of road infrastructure projects.

The Malaysian Road Conference and Exhibition 2018, currently tenth in its series, which will be held from 29 to 31 October 2018 is jointly organised by the Ministry of Works, Malaysia, Public Works Department of Malaysia, Malaysian Highway Authority, World Road Association (PIARC) and the Road Engineering Association of Malaysia in collaboration with the Construction Industry Development Board, Malaysia, International Road Federation Global and Road Engineering Association of Asia & Australasia.

Some 30 local and international papers will be presented and discussed at the technical and workshop sessions with one special lecture by an international expert each day. Senior managers and leading practitioners in road engineering from corporate sector organisations including officials from the government will present up to date, highly relevant and practical information on the increasingly complex road environment. The technical programme, which will include the PIARC International Seminar papers, is very flexible with a choice of speaking streams or workshops on each day. Delegates may freely swap between both streams.

CONFERENCE concurrent event

As in the last 2014 series, the MRC will be held simultaneously with the PIARC International Seminar on Asset Management. This seminar is held under the auspices of PIARC Technical Committee D.1 Asset Management. The objective, among others is to improve the quality and efficiency of road infrastructure through the effective management of assets in tandem with user expectations and government requirements.

OFFICIAL LANGUAGE of Conference / Seminar

The proceedings of the Conference/Seminar will be in English.

PIARC in brief

The forerunner of the renamed World Road Association, Permanent International Association of Road Congresses (PIARC), was established in Paris in 1909. Though a name change had taken place, the acronym PIARC had been retained. Today, more than a century later, this association has close to 150 member countries worldwide, including Malaysia. PIARC is dedicated to foster and facilitate discussions and knowledge sharing on roads and road transportation and retains consultative status to the Economic and Social Council of the United Nations.

CONFERENCE / SEMINAR theme

"Global Approaches to Advance Road Asset Management"

Road infrastructure is pivotal for sustained economic growth and social progress. These assets are costly, not only to build but also to maintain at optimum operating level to meet the raising aspirations of the user public. Increase in traffic volume, growing population, an aging asset base and the ever escalating operating and maintenance cost weigh heavily on the existing road network. Against this backdrop, it is imperative to increase the efficiency and longevity of the existing road infrastructure assets.

The technical sessions in this conference and seminar have been formulated to find answers and face the challenges ahead.



MALAYSIA: A must visit destination

Malaysia, situated in central Southeast Asia comprising 12 states in peninsula and two in the north coast of the island of Borneo across the South China Sea is blessed with an exotic mix of million-year old rainforests housing an abundant variety of fascinating fauna and flora, island resorts and sandy beaches, cool hill stations and breathtaking skyscrapers and charming heritage buildings. This nation, a melting pot of Malay, Chinese, Indian and indigenous people of Sabah and Sarawak with their own unique traditions and cultural festivals, is an inspiring testimony to unity in diversity.

Come participate in this conference and seminar and savour the warmth of Malaysian hospitality. Spoil yourselves in the world class facilities, immerse yourselves inside the bewildering range of shopping malls and treat your palates with the tantalising flavours and textures of local and international cuisines.



CONFERENCE / SEMINAR: venue

This joint event will be held at the Sunway Pyramid Convention Centre in the city of Petaling Jaya located in the suburbs of Malaysia's capital city of Kuala Lumpur. Fondly called PJ, this vibrant city is a haven boasting a potpourri of gastronomic delights, shopping treasures and exhilarating entertainment destinations including a theme park within and in the vicinity of the venue.



For further enquiries, please contact:
Email: enquiries@10mrc.com
Tel.: +603-2618 4602 / 4510 / Fax: +603-4041 1993
Email: ream@ream.org.my
Tel: +603-5523 6533 / Fax: +603-5513 6523

Invitation to submit Technical Papers

Deadline for Abstracts: 1 April 2018

Deadline for Full Papers: 15 July 2018

Submit online at:
technicalprogramme@10mrc.com

Papers are invited from local and international authors encompassing, among others, the following streams in tandem with the conference / seminar theme **"Global Approaches to Advance Road Asset Management"**. Papers should be written in the following topics:

| Road Asset Management |
|-------------------------------------|
| Traffic Control and Management |
| Road Safety Management |
| Design and Construction Technology |
| Geospatial Information System (GIS) |
| Public Transportation |

Accepted papers will be considered for the SCOPUS indexed publications.

Papers shall be submitted in two (2) stages; first as an **abstract** and then as a **full paper** after the abstract has been accepted. Papers submitted should be original and have not been published and/or presented elsewhere.

Awards for outstanding papers

Towards the objective of encouraging greater participation by Malaysians, cash awards and certificates will be awarded to the best three (3) papers. All papers must be authored / co-authored and presented by Malaysians.

Format for Abstracts

- All submissions must be in **English** and about 300 words in length.
- Double spacing on A4 size paper (210 mm X 297 mm) in Microsoft Word or PDF format.
- Author/co-author(s) name(s), title(s), position(s), organisation(s) and contact address(es) (including email address(es)) should be provided in the abstract.
- The presenting author's name must be underlined.

Submission of email address(es) is essential. Most, if not all correspondence shall be carried out via email.

Deadline for Abstracts 01 April 2018

Deadline for Full Papers

Authors will be informed of the acceptance of their abstracts via email by **15 May 2018**.

| Highway Planning |
|--|
| Sustainable Road Construction Practices |
| Road Financing and Public-Private Partnership |
| Innovations in Pavement, Materials and Geotechnical Engineering |

Deadline for full paper submission is **15 July 2018**. Full papers must be submitted in a Microsoft Word and PDF format according to the Guidelines for Full Paper Submissions that will be uploaded onto the official website.

Authors will be informed of the full paper acceptance via email by **15 September 2018**.

Author(s) of accepted full paper(s) need to prepare a camera-ready (final) version for inclusion in the Conference / Seminar Proceedings. Camera-ready (final) version will be substantially the same as the full paper but will take into account reviewer's comments. Camera-ready (final) version must be submitted via email by **01 October 2018**.

Submission of Abstracts / Full Papers and Enquiries

All abstracts and full papers must be submitted to the **Technical Programme Committee, 10th Malaysian Road Conference & Exhibition 2018**. Email: technicalprogramme@10mrc.com

For further enquiries, please contact:
Email: technicalprogramme@10mrc.com
Tel: +603-2618 7964 (Lim Chi Chon)
Tel: +603-8946 6390 (Dr. Fauzan Mohd Jakarni)

Disclaimer

Invitation to submit an abstract / full paper does not constitute an offer to pay travel, accommodation or registration costs associated with the conference / seminar. By submitting an abstract, you will be granting the Organising Committee permission to publish the abstract and the subsequent full paper in the Conference / Seminar Proceedings.

PRELIMINARY PROGRAMME (Subject to changes)

MRC Sessions

Combined MRC
& PIARC Sessions

PIARC Seminar Sessions

Exhibition

PIARC TC Meetings

| Date | 28 October 2018 (Sunday) | 29 October 2018 (Monday) | 30 October 2018 (Tuesday) | 31 October 2018 (Wednesday) | 1 Nov 2018 (Thursday) | 2 Nov 2018 (Friday) | Date |
|-------------|--|--|---------------------------------|---|--|--|-------------|
| Time | CONFERENCE & SEMINAR | CONFERENCE & SEMINAR | CONFERENCE & SEMINAR | CONFERENCE & SEMINAR | PIARC TC D.1 | PIARC TC D.1 | Time |
| 0800 - 0830 | | Registration | Registration | Registration | | | 0800 - 0830 |
| 0830 - 0900 | | | | | | | 0830 - 0900 |
| 0900 - 0930 | | Plenary Session 1 Guest Speaker 1 (From PIARC) Guest Speaker 2 (TBD) Pyramid 1 & 2 | | MRC Technical Session 10: GIS Geospatial Information System (Pyramid 3) | | | 0900 - 0930 |
| 0930 - 1000 | | | | Plenary Session: PIARC Panel Discussion on Asset Management (Pyramid 3) | | | 0930 - 1000 |
| 1000 - 1030 | | | | Network Break | | | 1000 - 1030 |
| 1030 - 1100 | | Network Break | | Network Break | PIARC TC D.1 Meeting (Luxor 6,7 & 8) | PIARC TC D.1 Meeting (Luxor 6,7 & 8) | 1030 - 1100 |
| 1100 - 1130 | | | | | | | 1100 - 1130 |
| 1130 - 1200 | | Opening Ceremony Keynote Address by the Minister of Work, Malaysia Presentation of Road Engineering Excellence Awards 2018 (Pyramid 1 & 2) | | Closing Ceremony Closing Address by Deputy Minister of Works, Malaysia Presentation of Best Paper Awards Presentation of MRC-IE Awards (Pyramid 1 & 2) | | | 1130 - 1200 |
| 1200 - 1230 | | | | | | | 1200 - 1230 |
| 1230 - 1300 | | | | | | | 1230 - 1300 |
| 1300 - 1330 | | Lunch (Pyramid 3) | | Lunch (Pyramid 1 & 2) | Lunch (Luxor 4) | Lunch (Luxor 4) | 1300 - 1330 |
| 1330 - 1400 | | | | | | | 1330 - 1400 |
| 1400 - 1430 | | | | | | | 1400 - 1430 |
| 1430 - 1500 | | | | | | | 1430 - 1500 |
| 1500 - 1530 | | PIARC Seminar Session 1: Asset Management (Pyramid 1 & 2) (Luxor 1,2 & 3) | MRC Workshop 1 (Luxor 7 & 8) | MRC Technical Session 9: Project Funding Policy (Luxor 1,2 & 3) | PIARC TC D.1 Meeting (Luxor 6,7 & 8) | PIARC TC D.1 Meeting (Luxor 6,7 & 8) | 1500 - 1530 |
| 1530 - 1600 | | | | | | | 1530 - 1600 |
| 1600 - 1630 | | | | | | | 1600 - 1630 |
| 1630 - 1700 | | | | | | | 1630 - 1700 |
| 1700 - 1730 | | | | | End of Conference & Seminar | | 1700 - 1730 |
| 1730 - 1800 | | | | | | | 1730 - 1800 |
| Date | 28 October 2018 (Sunday) | 29 October 2018 (Monday) | 30 October 2018 (Tuesday) | 31 October 2018 (Wednesday) | 1 Nov 2018 (Thursday) | 2 Nov 2018 (Friday) | Date |
| | Registration of delegates (CP3 Foyer) | Pre-registration & briefing to speakers (Multi-purpose rooms) | | | | | |

AUDIENCE targeted

The joint event is programmed to invoke interest in all those in the road industry, be they road concessionaires, expressway regulators, related government authorities, consultants, contractors, project managers and engineers from public and corporate sector organisations. Based on the overwhelming response to the past nine MRCs, some 800 local and overseas delegates are expected to register for this much awaited event. Overseas delegates will have the invaluable opportunity of sharing the Malaysian experiences in the various fields of road asset management and engineering.

CONTINUING PROFESSIONAL DEVELOPMENT (CPD) hours

Participating professional engineers registered with Board of Engineers, Malaysia will be accorded 20 CPD hours.

REGISTRATION fee

| Registration category | Registration Fee | | |
|---------------------------------------|------------------------------------|-----------------------------------|----------------|
| | Regular (until 23 October 2018) | On-site (from 24 October 2018) | Daily rate |
| Delegate | RM1,900.00 | RM2,000.00 | RM1,000.00/day |
| REAM members & public sector officers | RM1,700.00 | | |
| Students | RM 500.00 | | |
| Speakers | RM1,000.00 | | |
| Student presenters | Free | | |

Note:

- Regular and On-site registrants for the full 3-day conference / seminar will receive the conference / seminar kit, attendance at the opening and closing ceremonies, all technical sessions and workshops, exhibition, one technical tour and refreshments provided during the period.
- Daily rate registrants for any one day will receive the conference / seminar kit, attendance at the sessions, entry to the exhibition and refreshments scheduled during that day.
- Registrations (walk-in) after **24 October** can only be done on-site.
- Students are required to submit an official letter from their respective universities confirming their status as current students and present their student cards at the conference / seminar registration desk.

Registration cancellation policy

| Cancellation cut-off dates | Refunds |
|---|---------------------------|
| Cancellations received on or before 15 May 2018 | 90% refund of amount paid |
| Cancellation received between 16 May 2018 - 14 September 2018 | 75% refund of amount paid |
| Cancellation received on or after 15 September 2018 | No refund |

Note:

- Any intended cancellation should be notified in writing to the Registration Committee at registration@10mrc.com.
- All due dates are based on Malaysian Standard Time (GMT+8)

Prompt action in registering before the 23 October 2018 dateline will enable participants to benefit from the reduced registration fee offered and obtain firm confirmation for their choice of technical visit, each of which has limited seats.

For further enquiries, please contact:
Email: registration@10mrc.com
Tel: +603-2618 7260 / 4668 / 4551
Fax: + 603-4041 1993

EXHIBITION participation

Road industry entrepreneurs are invited to participate in the exhibition held simultaneously with this joint conference and seminar which will enable them to reinforce their respective organisation's role as a leader by showcasing their expertise, products and services and innovative outcomes to an interested, relevant and influential audience.

Exhibitions are pivotal to an integrated marketing strategy as they provide the springboard for:

- Promoting an organisation's achievements and unique contributions to the industry
- Networking with targeted key decision makers from public and corporate sectors
- Establishing new contacts and exchanging ideas and views
- Tapping into expertise brought forth by the conference / seminar

A total of 110 lots measuring 3m x 3m have been made available. Exhibitors have the choice of opting for the standard shell scheme measuring nine (9) sq. metres or the raw space for which a minimum of 18 sq. metres must be requested. **Please see booth layout overleaf.**

Booking rates for shell scheme and raw space

| Standard shell scheme | Booth category | Booking rates |
|---|--|-------------------------|
| Facilities provided for standard shell scheme measuring nine (9) sq. metres (3m x 3m) | Platinum | RM 12,000.00 |
| • Side / back panels and fascia board with exhibitor's name | Gold | RM 10,000.00 |
| • One table | Silver | RM 8,000.00 |
| • Two (2) units folding chairs | Bronze | RM 6,000.00 |
| • One (1) unit 13 amps single phase socket | RAW SPACE | RM 600.00 per sq. metre |
| • Two (2) units 40w fluorescent lights | Upon request for a minimum of 18 sq. metres (2-booth size) | |
| • One (1) waste paper basket | | |

Exhibitor entitlements

- One (1) free conference / seminar registration for each booth taken.
- Exhibitor profile not exceeding 100 words will prominently appear in the Exhibitor Show Directory
- Two (2) exhibitor passes for each booth taken.

Malaysian Road Conference Invention & Innovation Exhibition (MRC - IIE 2018)

Background

The inaugural MRC - IIE was concurrently held with the 9th MRC in 2014. The event culminated in a resounding success following overwhelming response from institutions of higher learning and the public and corporate sectors.



Objective

Towards encouraging new research and development among the academicians and students from institutions of higher learning, engineers, public authorities and the corporate sector, REAM and the Malaysian Highway Authority (MHA) have conceptualised a platform by way of an exhibition to bring innovators and the relevant industries together to pave the way for better and quality roads in Malaysia. This would also enhance technological communication between road construction and maintenance departments, construction enterprises and manufacturers of road construction and maintenance equipment. New inventive and innovative products displayed at the exhibition will be judged by professional international / national juries for the award of Gold, Silver and Bronze Medals. Sponsored International Awards are also expected to be given to high achieving break-through inventions and innovative technologies and products.

Scope and judging categories

Encompassing among others:

| | | |
|---|---------------------------------------|--|
| Materials for roads and bridges | Geotechnical aspects for roads | Traffic control devices |
| Road safety | Highway slope protection | Highway, bridge and slope related software |
| Roads and bridge management systems | Signage gadgets for roads and bridges | Clean energy and environment |
| Equipment and devices for road & bridge testing | | |

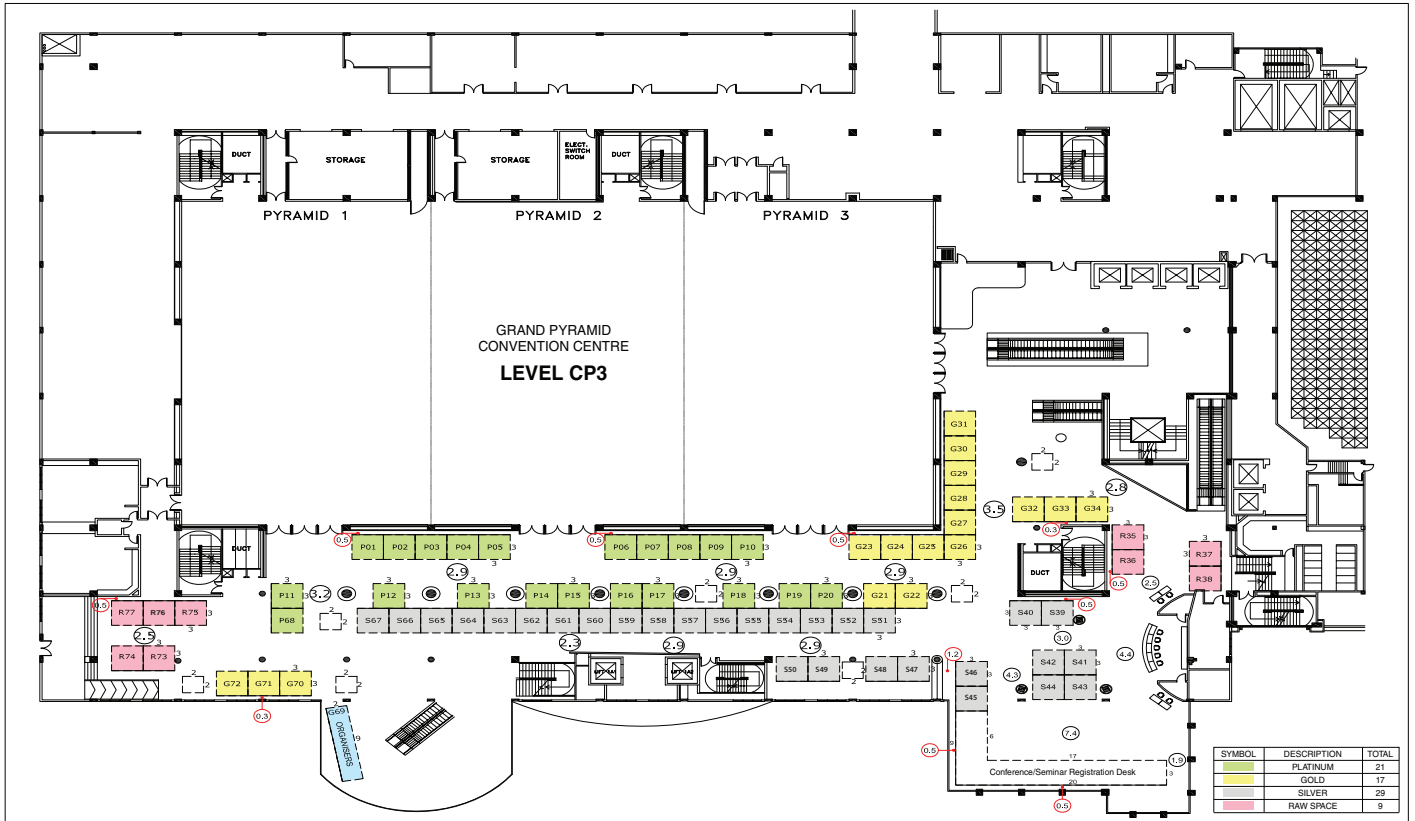
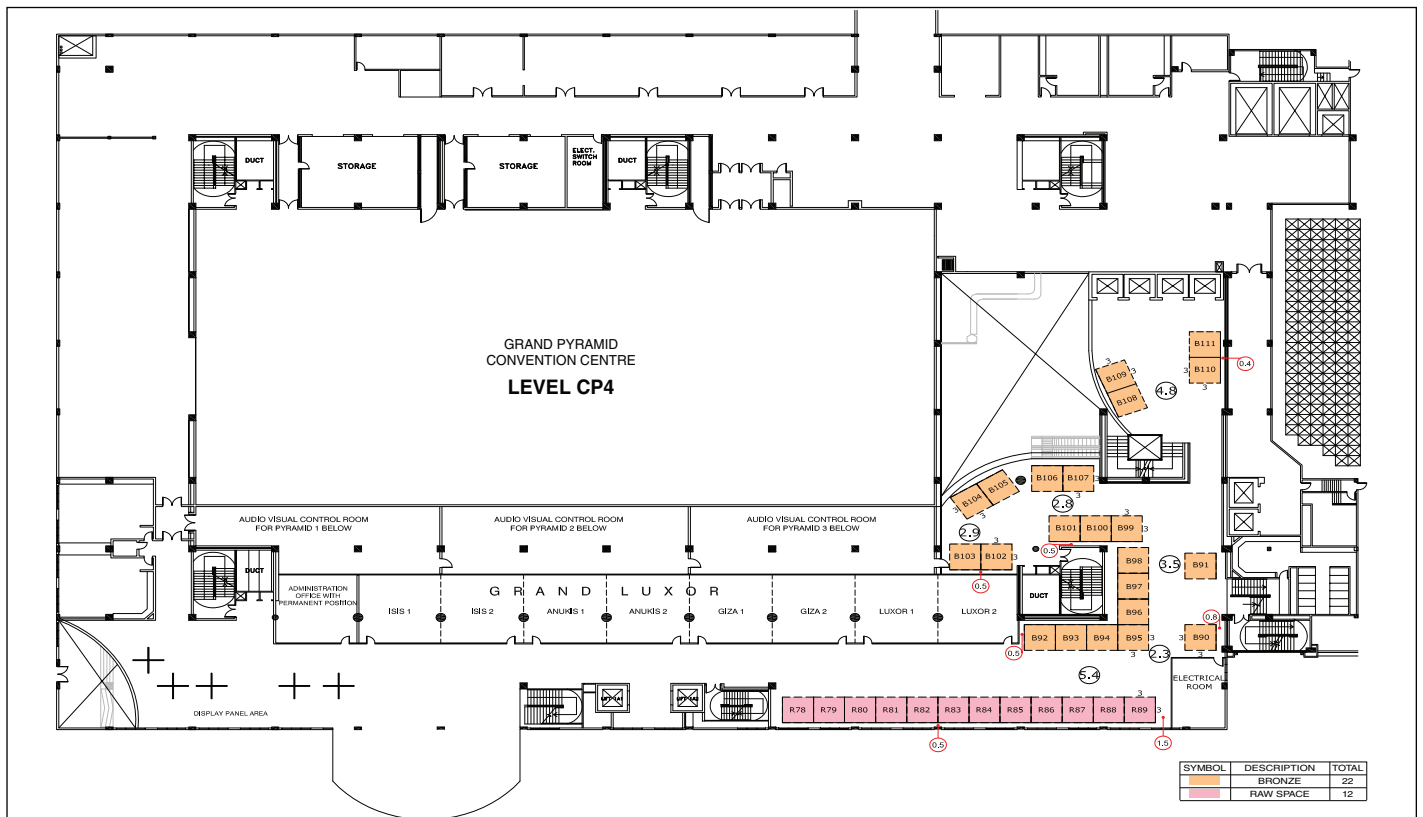
Exhibition Area 'A' - Level 3

Exhibition Area 'B' - Level 4

For further enquiries, please contact:
 Email: exhibition@10mrc.com
 Tel: 016-345 0605 (Atikaa), 016-673 6660 (Kamarul)
 013-624 4292 (Najib), 010-231 5100 (Suhaimi)
 Fax: 03-8737 4035

PARTNERSHIP opportunities

The conference and seminar offer exciting avenues ranging from partnerships, event activities and many more to create a strong presence of your company in this event. We encourage you to take advantage of this opportunity.

Do not miss this opportunity to be our partner in this joint event...

PLATINUM PARTNER (RM 100,000.00)

- Company's name & logo in official materials
 - 1 Platinum exhibition booth
- 1 Full page color advertisement in souvenir programme book
- Complimentary VIP Tickets (Opening Ceremony, **BUSINESS NETWORKING SESSION**)
- 5 Complimentary Conference/Seminar registrations and additional (2) registrations if confirmed before 30 June 2018
- Technical paper presentation slot at the Conference / Seminar

GOLD PARTNER (RM 50,000.00)

- Company's name & logo in official materials
 - 1 Gold exhibition booth
- 1 Full page color advertisement in souvenir programme book
- Complimentary VIP Tickets (Opening Ceremony, Business Networking Session)
- 3 Complimentary Conference/Seminar registrations and additional (1) registration if confirmed before 30 June 2018

SILVER PARTNER (RM 30,000.00)

- Company's name & logo in official materials
 - 1 Silver exhibition booth
- 1 Full page color advertisement in souvenir programme book
- Complimentary VIP Tickets (Opening Ceremony, Business Networking Session)
- 2 Complimentary Conference/Seminar registrations and additional (1) registration if confirmed before 30 June 2018

EXECUTIVE PARTNER (RM 5,000.00)

- Company's name in souvenir programme book
- Complimentary VIP Ticket (Business Networking Session)
- 1 Complimentary Conference/Seminar registration

OR

Be a sponsor for our special event activities, conference materials, advertising etc.

BUSINESS NETWORKING session

One Session, Multiple Connections!

The session, tentatively scheduled on Day 1 of the conference / seminar from 5.30 – 7.30pm, will provide a platform for local and international industry leaders and entrepreneurs to engage and expand their business network. So, register for this session... and widen your reach.

Fee

| Category | RM |
|--------------|--------|
| Delegate | 50.00 |
| Non-Delegate | 250.00 |

For further enquiries, please contact:
 Email: sponsorship@mrc10.com
 Tel: +603 5513 6521/ 6522
 Fax: +603 5513 6523



ROAD ENGINEERING EXCELLENCE AWARD 2018

Introduction

The Road Engineering Association of Malaysia (REAM) invites entries for its Road Engineering Excellence Award, which will be conferred in conjunction with the Malaysian Road Conference. This award was introduced to give recognition to the most outstanding road engineering project built within Malaysia. The Road Engineering Excellence Award 2018 will be presented at the 10th Malaysian Road Conference / PIARC International Seminar. This prestigious award was first introduced in 2002.

Objective

- To recognise outstanding achievements in road engineering in terms of project function, design, construction and operation.
- To promote the development of quality built environment that contributes towards economic and social development of the country.
- To promote public awareness of outstanding road engineering projects.

Award eligibility

The following types of projects, singularly or in combination, are eligible for consideration:

- Roads / highways
- Bridges
- Tunnels
- Structures related to roads / highways

The project must be built within Malaysia, completed and operational during the period January 2015 - June 2018.

Award criteria

- Contribution towards the economic and social wellbeing of the community served by the project in particular, and the nation in general.
- Resourcefulness and innovation in planning, design, construction and solution of problems.
- Safety features and operational safety record.
- Preservation and protection of environment.
- Pioneering use of materials and methods, particularly those of Malaysian origin.
- Incorporation of futuristic and aesthetic values.

Award

The Award consists of one challenge trophy, three replicas and three certificates. The Project Owner, the Principal Designer and the Principal Contractor of the winning project shall each be awarded a replica and a certificate. The Project Owner shall be entitled to keep the challenge trophy for a period of six (6) months, after which it shall be returned to REAM.

Presentation of award

The Road Engineering Excellence Award 2018 is expected to be presented by the Minister of Works, Malaysia at the opening ceremony of the 10th Malaysian Road Conference / PIARC International Seminar.

Panel of judges

A panel of not less than three (3) judges comprising prominent personalities in the road engineering industry will be invited to review and select the winning entry.

The panel of judges shall have absolute discretion to accept or reject entries that do not comply with the requirements of the rules. The judges' discretion shall be final and binding on all entries and no discussion or correspondence whatsoever relating to any of the judges' decision shall be entered into.



How to enter

Entries in typewritten form must contain the following data:

- Name of owner
- Name of project
- Location of project
- Date fully operational
- Name of principal designer
- Name of principal contractor
- Name, address, telephone / fax nos. of person / organisation submitting the entry

A brief on the project on two (2) single-sided A4 size paper containing not more than 500 words with the following descriptions:

- Why the project should be considered for this award
- The purpose of the project
- The design approach
- Reasons for the method of construction and
- Any other details considered relevant to the judging criteria

Entries should include, if available, the following to illustrate the salient features of the project:

- Layout plan (on A3 size paper)
- Progress photographs
- Video clippings from implementation to completion

A short edited version of the video clippings / photographs of the winning entry may be screened during the award presentation ceremony.

Closing Date

All nominations must arrive no later than Wednesday, 15 August 2018 at:

Secretariat for Road Engineering Excellence Award 2018

Road Engineering Association of Malaysia
46A, Jalan Bola Tampar 13/14
40100 Shah Alam, Selangor

For further enquiries, please contact:

Email: ream@ream.org.my

Tel: +603-5513 6521 / 6522

Fax: +603-5513 6523

TECHNICAL VISIT venues

An enlightening schedule of technical visits has been arranged to showcase Malaysia's efforts to meet the accelerating demand for an efficient road and transportation infrastructure. Delegates are requested to select one (1) visit of their choice. Due to space constraints at the venues, registration will be on first come, first served basis.

TECHNICAL VISIT 1 RAWANG BYPASS

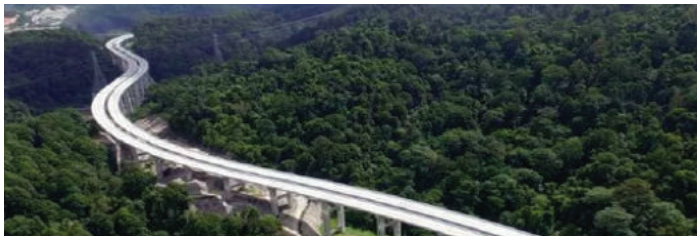

The Rawang Bypass which was opened to traffic in November 2017, involves a new road alignment to bypass the busy Rawang town. The project cuts through a hilly and environmentally-sensitive forested heritage park which has been a traditional location for family outings, nature lovers and eco-tourists. Major mitigation initiatives were considered in its engineering design, including the construction of a viaduct and localised cutting of the slopes. Movement of wildlife is made possible below the entire stretch of the viaduct. A careful construction methodology was used with the view to mitigate disturbance to the existing environment and ecosystem during construction. It would be interesting to follow the approaches adopted by the Public Work Department in undertaking the project with minimal environmental impact and the asset management scheme utilised to maintain this important asset.

TECHNICAL VISIT 2 MASS RAPID TRANSIT



The 51-kilometre MRT Sungai Buloh to Kajang Line (MRT Line 1) was completed in 2017. It is the first of the three planned Klang Valley Mass Rapid Transit lines to be commissioned.

The line has a total of 31 stations consisting of 7 underground stations and 24 elevated stations. MRT Line 1 spans between Sungai Buloh and Kajang towns. The alignment starts from Sungai Buloh which is located at the north-west of Kuala Lumpur, runs through the city centre of Kuala Lumpur, and ends in Kajang, a fast developing town centre located at the south-east of Kuala Lumpur. There are two depots which are located in Sungai Buloh and Kajang. The scope of asset management for such a mega project is complex, challenging and involves asset maintenance and asset condition audits on the rolling stock, systems and all other assets.

TECHNICAL VISIT 3 PLUS TRAFFIC MONITORING CENTRE



The Traffic Monitoring Centre (TMC) of PLUS was established in 2008 at Subang and operates round the clock to ensure smooth traffic movement as well as to improve road safety aspects of approximately 60% of all tolled highways in Peninsular Malaysia.

The TMC is equipped with the Intelligent Transportation System and provides real time traffic information to highway users via variable message signboards, portal web, closed circuit TV, short messaging system and multimedia messaging systems.

TMC also liaises with relevant authorities and provides tow truck services for faster incident/breakdown clearance on the highways.

TECHNICAL VISIT 4 DUKE 2 EXPRESSWAY



The Duta-Ulu Klang Expressway 2 (DUKE 2) is a prominent part of the Kuala Lumpur Road Master Plan acting as a key traffic dispersal and extension to the existing DUKE. It is designed to be a dual-three lane tolled carriageway which will connect the east and west of Kuala Lumpur via a seven-kilometre link from Sri Damansara and a nine-kilometre link from Jalan Tun Razak. The construction works for DUKE 2 commenced in 2014 and were completed by end of 2017. The visit will focus on how the concessionaire manages and sustains tolled expressways over the asset life cycle in a cost effective manner.

TECHNICAL VISIT 5 MEX EXPRESSWAY



The Maju Expressway (MEX) with a total length of 26km connects the Kuala Lumpur central business district with the Putrajaya administrative centre and onwards to the Kuala Lumpur International Airport (KLIA). The expressway is a 3-lane dual carriageway which provides the fastest and shortest connection between these key points and serves as the Gateway to the Nation. MEX was completed in 2007. The expressway is currently being extended further to KLIA and is expected to be completed in 2019. MEX is a fully access controlled expressway with major interchanges providing connectivity with other major highways and development corridors in the Greater Klang Valley. Having managed this major expressway for over 10 years, the concessionaire has in depth experience to share in terms of asset management for the toll plaza, pavement, slopes, bridge and administrative and supervision buildings.

For further enquiries, please contact:
Email: technicalvisits@10mrc.com
Tel: +603-9173 0355 (Sivaanathan/Low Kian Yung)
Fax: +603-9173 9663

ACCOMMODATIONS choices

There are numerous hotels with various star ratings within the vicinity of Sunway Pyramid Convention Centre (SPCC), the conference/seminar venue. Delegates wishing to stay in the following hotels closest to the conference/seminar venue are requested to communicate directly with the hotels for their requirements.



For further enquiries, please contact:
Email: accommodation@10mrc.com
Tel: +603-2771 4229 / 2771 4233
Fax: +603-2711 3975



Sunway Resort Hotel



Sunway Pyramid Hotel



Sunway Clio Hotel



Dorsett Grand Subang



Summit Hotel Subang USJ

| Hotel | Telephone | Email | Website |
|---|----------------|--|--|
| Sunway Resort Hotel & Spa (directly linked to SPCC) | +603-7492 8000 | srhs.enquiry@sunwayhotels.com | kualalumpur.sunwayhotels.com |
| Sunway Pyramid Hotel (directly linked to SPCC) | +603-7492 8000 | srhs.enquiry@sunwayhotels.com | kualalumpur.sunwayhotels.com |
| Sunway Clio Hotel (walking distance to SPCC) | +603-7492 8000 | srhs.enquiry@sunwayhotels.com | kualalumpur.sunwayhotels.com |
| Dorsett Grand Subang | +603-5031 6060 | reservation.subang@dorsetthotels.com | www.dorsetthotels.com |
| Summit Hotel Subang USJ | +603-8023 3000 | reservation@summithotel.com.my | www.summithotelusj.com |

PIARC *INTERNATIONAL SEMINAR ON* **ASSET MANAGEMENT** **2018**

in conjunction with
10TH MALAYSIAN ROAD CONFERENCE & EXHIBITION 2018
29 – 31 OCTOBER 2018
PETALING JAYA, SELANGOR, MALAYSIA

“Global Approaches to Advance Road Asset Management”

FIRST ANNOUNCEMENT

Jointly organised in collaboration with:

PIARC Technical Committee D.1 on Asset Management
Ministry of Works, Malaysia
Public Works Department, Malaysia
Malaysian Highway Authority
Construction Industry Development Board, Malaysia
Road Engineering Association of Malaysia
International Road Federation Global
Road Engineering Association of Asia & Australasia



Introduction

The PIARC Technical Committee D.1 on Asset Management with the support of the Ministry of Works, Malaysia takes great pleasure in inviting you participate in this ***International Seminar on Asset Management***. A concurrent event, the 10th Malaysian Road Conference will also be held.

Road infrastructure is pivotal for sustained economic growth and social progress. These assets are costly, not only to build but also to maintain at optimum operating level to meet the raising aspirations of the user public for safe travel. Increase in traffic volume, growing population, an aging asset base and the ever escalating operation and maintenance cost weigh heavily on the existing road networks. Against this backdrop, it is imperative to increase the efficiency and longevity of the existing road infrastructure assets.

Seminar focus

Carrying the theme ***Global Approaches to Advance Road Asset Management***, the primary focus will be on topics related to the conservation, rehabilitation and management of road infrastructure which will be addressed by renowned national and international experts. Related topics on the use of cutting edge sustainable technologies in the engineering and construction of road infrastructure will also be highlighted.

The Seminar technical programme which will also include the 10th Malaysian Conference papers is very flexible with a choice of speaking streams and workshops on each day. Delegates may freely swap between both streams.

Seminar objectives

The primary objectives, among others are to:

- Disseminate knowledge and experiences acquired over recent years, both locally and internationally on the design, construction, conservation, rehabilitation and management of road infrastructure related assets
- Provide a platform for the attending delegates for in depth discussions with presenting experts and
- Contribute towards the overall improvement of road infrastructure and related assets

Official language

The proceedings of the Seminar and the concurrent Conference will be English.

Call for papers

Papers are invited from local and international authors encompassing, among others, the following streams in tandem with the conference / seminar theme ***“Global Approaches to Advance Road Asset management”***. Accepted papers will be considered for the SCOPUS indexed publications.

Papers shall be submitted in two (2) stages; first as an **abstract** and then as a **full paper** after the abstract has been accepted. Papers submitted should be original and have not been published and/or presented elsewhere.

Papers shall be submitted in two (2) stages; first as an **abstract** and then as a **full paper** after the abstract has been accepted. Papers submitted should be original and have not been published

Format for Abstracts

All submissions must be in English and about 300 words in length.

- Double spacing on A4 size paper (210 mm X 297 mm) in Microsoft Word or PDF format.
- Author/co-author(s) name(s), title(s), position(s), organisation(s) and contact address(es) (including email address(es)) should be provided in the abstract.
- The presenting author's name must be underlined.

Submission of email address(es) is essential. Most, if not all correspondence shall be carried out via email.

Deadline for Abstracts – 31 May 2018

Deadline for Full Papers

Authors will be informed of the acceptance of their abstracts via email by **15 June 2018**.

Deadline for full paper submission is **10 July 2018**. Full paper must be submitted in a Microsoft Word and PDF format according to the Guidelines for Full Paper Submissions that will be uploaded onto the official website.

Authors will be informed of the full paper acceptance via email by **15 September 2018**.

Author(s) of accepted full paper(s) need to prepare a camera-ready (final) version for inclusion in the Conference / Seminar Proceedings. Camera-ready (final) version will be substantially the same as the full paper but will take into account reviewer's comments. Camera-ready (final) version must be submitted via email by **01 October 2018**.

Submission of Abstracts / Full Papers and Enquiries

All abstracts and full papers must be submitted to Ms. Nafisah binti Abdul Aziz, Chairperson, PIARC International Seminar on Asset Management Coordinating Committee, Email: nafisah@roadcare.com.my Tel: 6019-237 9434 / 603-9285 4270

List of confirmed speakers from PIARC TC D1 Asset Management

| Speaker | Position | Title of Paper | Country |
|---|--|--|-------------|
|  <p>Dr. Ing. Thomas LINDER</p> | Road Network Manager for Southern Bavaria, Bavarian State Ministry of the Interior, for Building and Transport | To deliver the appropriate Road Infrastructure – a huge challenge at present and in the future | Germany |
|  <p>David K. HEIN</p> | Manager, ARA Transportation Infrastructure Division | <ol style="list-style-type: none"> 1. Experiences and challenges in managing assets for public/private/partnership highway projects in Canada 2. Lessons Learned and Readiness Assessment of Canadian Roadway Agencies Implementation of Transportation Asset Management | Canada |
|  <p>Ricardo SOLORIO</p> | Research workgroup leader, Road Infrastructure Management, Mexican Institute of Transport | <ol style="list-style-type: none"> 1. Works programming in the PIARC Asset Management Manual 2. Actual status on HDM-4 and further outlook | Mexico |
|  <p>Shigeru SHIMENO</p> | Senior Expert of East Nippon Expressway Company Limited | Development of a new generation of Road Maintenance Information Systems towards the advanced asset management practices in expressways | Japan |
|  <p>Rade HAJDIN</p> | President at Infrastructure Management Consultants GmbH | Risk based asset management | Switzerland |



Sam BEAMISH

Technical Director -
Asset Management,
Kier Highways

ISO 55 001 certification: an
example from UK

United Kingdom



Yuli PAN

Director of
China National
Engineering Research
Centre of Road
Maintenance
Technologies
Beijing, China

Asset management of China's trunk
road network

Japan



Gerardo FLINTSCH

Director of the Centre
for Sustainable
Transportation
Infrastructure

Professor Virginia Tech
Transportation Institute

1. PIARC efforts for training the
next generation of asset
managers
2. Managing assets in the age of
autonomous vehicles, intelligent
infrastructure and human-
centred communities

United States of
America

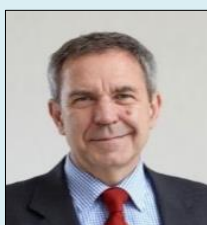

Slawomir HELLER

Senior Consultant and
Owner at HELLER
Ingenieurgesellschaft
mbH, Darmstadt

Asset management vs. managing
assets

Germany



Rongji CAO

Chief Engineer, JSTI
Group
Director, National
Engineering Laboratory
for Advanced Road
Materials

Pavement Condition Assessment
and Maintenance Strategy Analysis

China



Marcin NOWACKI

General Directorate for
National Roads and
Motorways

Asset management in eastern
European climate

Poland



Fernando VARELA
SOTO

Department Director of
Civil Engineering:
Construction,
Infrastructure and
Transport,
Polytechnic University
of Madrid

Asset management innovation for
rigid pavements

Spain



Darko KOKOT

Slovenian National
Building and Civil
Engineering Institute

Cross asset in the life-cycle based
asset management approach for
transport infrastructure (EU project
AM4INFRA)

Slovenia



Alfred Weninger –
Vycudil

The PIARC Asset Management
Manual – a guide for practitioners

Austria



David DARWIN

Education and dissemination – an
example for a short course on life
cycle planning

New Zealand



Hye Ok LEE

Deputy Managing Director/ Head of Planning Team, Korea Expressway Corporation

Long journey of road data integration management optimization

South Korea



Christian HONEGER

Head of Department and Authorized Signatory, ASFINAG Service GmbH, Vienna

Digitalisation in asset management

Austria

List of confirmed speakers - Local

| Speaker | Position | Title of Paper | Country |
|---|---|--|----------|
|  YDH Toh Paduka Setia Dato' Ir Safry Kamal Hj Ahmad | Territorial Chief (Orang Besar Jajahan) for the District of Muallim Former Perak State Public Works Department Director | Asset management: Educating the asset managers | Malaysia |
|  Dr. Voo Yen Lai | Executive Director & CEO; Dura Technology Sdn Bhd | Sustainable design innovation | Malaysia |
|  Azwan Ezzany Azmi | PhD candidate in Civil Engineering at the University of Birmingham Senior Engineer, Public Works Department | Maintenance management for high-risk roads | Malaysia |

Target audience

The Seminar and the concurrent Conference are programmed to invoke interest in all those in the road industry, be they road concessionaires, expressway regulators, related government authorities, consultants, contractors, project managers and engineers from public and corporate sector organisations. Overseas delegates will have the invaluable opportunity of sharing the Malaysian experiences in the various fields of road asset management and engineering.

Registration fee*

| | | |
|---|---|--------------------------------|
| i. Members of PIARC TC D.1 | - | Free registration |
| ii. PIARC Members (Non- TC D.1 Members) | - | Ringgit Malaysia (RM) 1,700.00 |
| iii. Paper Presenters | - | Ringgit Malaysia (RM) 1,000.00 |
| iv. Non PIARC Members | - | Ringgit Malaysia (RM) 1,900.00 |

*For payments received before 23 October 2018.

Registered delegates will be entitled to Seminar/Conference kit, attendance at all ceremonies, technical and workshop sessions and exhibition, one social and technical tour and daily refreshments.

PIARC Special Fund

The PIARC Special Fund can cover up to 100% of travel expenses or up to 100% of accommodation expenses of participants from developing countries (lower middle income and low-income countries). It can cover the expenses of one participant per PIARC member country, subject to the agreement of the First Delegate. Request for Special Fund should be made by the First Delegate to PIARC Secretary General, email: info@piarc.org

The rules relating to the use of the Special Fund are available on the PIARC website: www.piarc.org in Section 12 of the Blue Guide.

Event venue

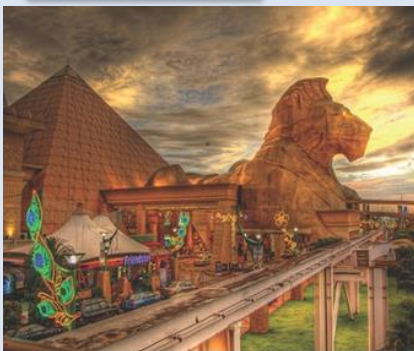

The Seminar and the concurrent Conference will be held at the Sunway Pyramid Convention Centre in the city of Petaling Jaya located in the suburbs of Malaysia's capital city of Kuala Lumpur. Fondly called PJ, this vibrant city is a haven boasting a potpourri of gastronomic delights, shopping treasures and

exhilarating entertainment destinations including a theme park within and in the vicinity of the venue.



With over 7,000 sq. metres of unobstructed space, is one of the preferred event destinations in the country bringing together leading technology, creative flavour and professional expertise to deliver an amazing hosting experience.

Exhibition Participation

Road industry entrepreneurs are invited to participate in the exhibition held simultaneously with this joint Seminar and Conference which will enable them to reinforce their respective organisation's role as a leader by showcasing their expertise, products and services and innovative outcomes to an interested, relevant and influential audience.

More than 100 spaces measuring 3m x 3m have been made available. Exhibitors have the choice of opting for the standard shell scheme measuring nine (9) sq. metres or the raw space for which a minimum of 18 sq. metres must be requested.

Booking rates for shell scheme and raw space

| Standard shell scheme | Booth category | Booking rates |
|---|---|-------------------------|
| Facilities provided for standard shell scheme measuring nine (9) sq. metres (3m x 3m) <ul style="list-style-type: none">• Side / back panels and fascia board with exhibitor's name• One table• Two (2) units folding chairs• One (1) unit 13 amps single phase socket• Two (2) units 40w fluorescent lights• One (1) waste paper basket | Platinum | RM 12,000.00 |
| | Gold | RM 10,000.00 |
| | Silver | RM 8,000.00 |
| | Bronze | RM 6,000.00 |
| | RAW SPACE Upon request for a minimum of 18 sq. metres (2-booth size) | RM 600.00 per sq. metre |

Exhibitor entitlements

- One (1) free conference / seminar registration for each booth taken.
- Exhibitor profile not exceeding 100 words will prominently appear in the Exhibitor Show Directory
- Two (2) exhibitor passes for each booth taken.

Exhibition Area 'A' – Level 3

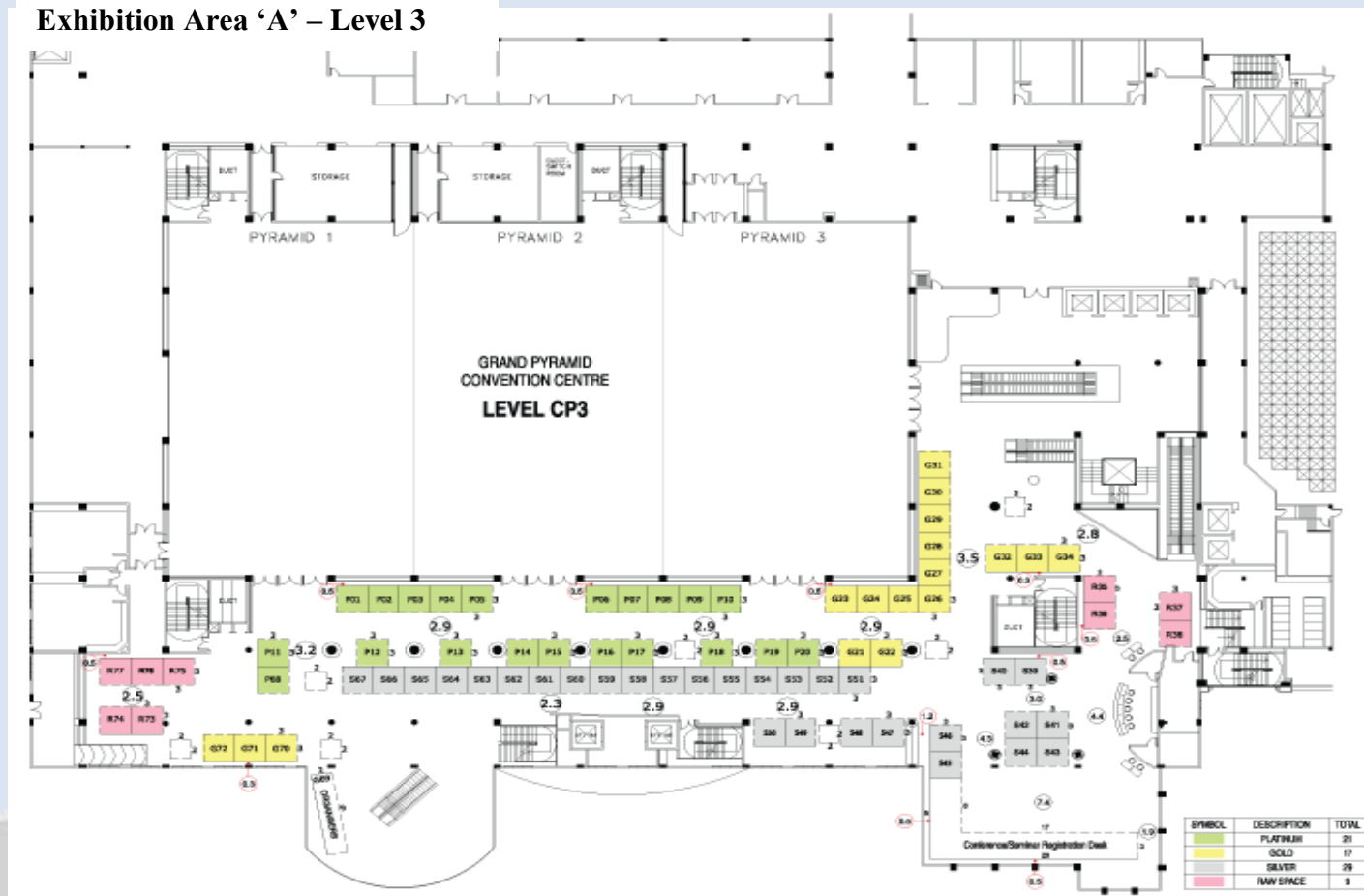

Exhibition Area 'B' – Level 4

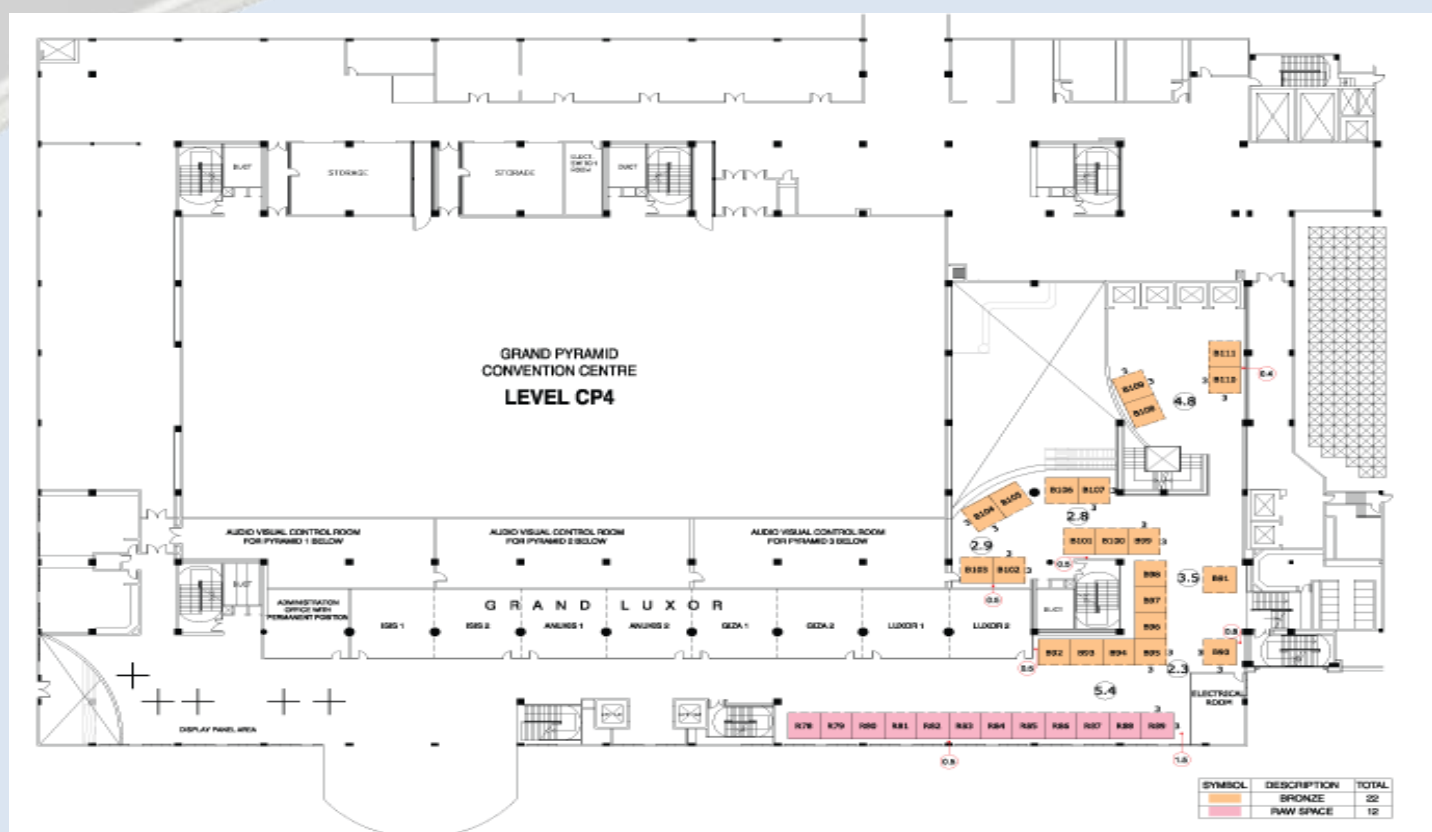

Technical visit venues

An enlightening schedule of technical visits has been arranged to showcase Malaysia's efforts to meet the accelerating demands for an efficient road and transportation infrastructure. Delegates are requested to select one (1) visit of their choice. Due to space constraints at the venues, registration will be on *first come, first served* basis.

Technical Visit 1: RAWANG BYPASS



The Rawang Bypass project, which was opened to motorists in November 2017, involves a new road alignment to bypass the busy Rawang town. The project cuts through a hilly and environmentally-sensitive forested heritage park which has been a traditional location for family outings, nature lovers and eco-tourists. Major mitigation initiatives were considered in its engineering design, including the construction of a viaduct and localised cutting of the slopes. Movement of wildlife is possible below the entire stretch of the viaduct. A careful construction

methodology was used with the view to mitigate disturbance to the existing environment and ecosystem during construction. It would be interesting to understand the approaches adopted by the Public Work Department to undertake the project with minimal environmental impact and the asset management scheme utilised to maintain this important asset.

Technical Visit 2: MRT LINE 1 – SUNGAI BULOH TO KAJANG



The 51-kilometre MRT Sungai Buloh to Kajang Line (MRT Line 1) was completed in 2017. It is the first of the three planned Klang Valley Mass Rapid Transit lines to be commissioned.

The line has a total of 31 stations consisting of 7 underground stations and 24 elevated stations. MRT Line 1 spans 51km between Sungai Buloh and Kajang. The alignment starts from Sungai Buloh which is located at the north-west of Kuala Lumpur, runs through the city centre of Kuala Lumpur, and ends in Kajang, a fast developing town located to the

south-east of Kuala Lumpur. There are two depots which are located in Sungai Buloh and Kajang. The scope of asset management for such a mega project is complex, challenging and involves asset maintenance and asset condition audits on the rolling stock, systems and all other assets.

Technical Visit 3: PLUS TRAFFIC MONITORING CENTRE



In 2008, the new Traffic Monitoring Centre (TMC) of PLUS was established in Subang and operates 24-hours every day to ensure smooth traffic movement as well as to improve road safety aspects of approximately 60% of all tolled highways in Malaysia.

The TMC is equipped with the Intelligent Transportation System (ITS) and provides real time traffic information to highway users via variable message signboards (VMS), portal web, circuit closed TV (CCTV) , short messaging system (SMS)

and multimedia messaging systems (MMS).

TMC also liaises with relevant authorities and provides tow truck services for faster incident/breakdown clearance on the highways.

Technical Visit 4: DUKE 2



Duta Ulu Kelang Expressway 2 (DUKE 2) is a prominent part of the Kuala Lumpur Road Master Plan acting as a key traffic dispersal and extension to the existing DUKE. It is designed to be a dual-three lane tolled carriageway which will connect the east and west of Kuala Lumpur via a seven-kilometre link from Sri Damansara and a nine-kilometre link from Jalan Tun Razak. The construction works for DUKE 2 commenced in 2014 and were completed by end of 2017. The visit will focus on how the concessionaire manages and sustains tolled expressways over the

asset life cycle in a cost effective manner.

Technical Visit 5: MEX (KL-PUTRAJAYA-KLIA)



Maju Expressway (MEX) with a total length of 26km connects the Kuala Lumpur central business district with the Putrajaya administrative centre and onwards to the Kuala Lumpur International Airport (KLIA). The expressway is a 3-lane dual carriageway which provides the fastest and shortest connection between these key points and serves as the Gateway to the Nation. MEX was completed in 2007 and is currently operated by the concessionaire, Maju Expressway Sdn Bhd. The expressway is currently being extended further to KLIA and is expected to be completed in 2019.

MEX is a fully access controlled expressway with major interchanges providing connectivity with other major highways and development corridors in the Greater Klang Valley. Having managed this major expressway for over 10 years, the concessionaire has in depth experience to share in terms in asset management for the toll plaza, pavement, slopes, bridge and administrative and supervision buildings.

MALAYSIA: A must visit destination

Malaysia, situated in central Southeast Asia comprising 12 states in peninsula and two in the north coast of the island of Borneo across the South China Sea is blessed with an exotic mix of million-year old rainforests housing an abundant variety of fascinating fauna and flora, island resorts and sandy beaches, cool hill stations and breath taking skyscrapers and charming heritage buildings. This nation, a melting pot of Malay, Chinese, Indian and indigenous people of Sabah and Sarawak with their own unique traditions and cultural festivals, is an inspiring testimony to unity in diversity.

Savour the warmth of Malaysian hospitality, enjoy the world class facilities, take in the bewildering range of shopping malls and street stalls and taste the tantalising flavours and textures of local and international cuisines.

Malaysia has emerged as a role model for countries worldwide due to its uniqueness in its combination of diverse people, religion and culture living in harmony as one large community. In short, Malaysia is a mini 'United Nations'. The hospitality traits of Malaysians are renowned and this has been the pivotal attraction for tourists and professionals alike. They come in droves to savour the Malaysian mosaic of cultures and colourful heritage and traditions.

Social Visit Venues

- ***Kuala Lumpur / Putra Jaya City Tour***



Kuala Lumpur City Tour (Half-day)

An enlightening introduction to the bustling cosmopolitan city of Kuala Lumpur. The city is a study in contrast between the gleaming hi-tech skyscrapers, the old colonial buildings and lush greenery. The visitors will have a chance to see some very interesting places such as Independence Square, King's Palace, National Monument, Old Railway Station, National Mosque and Petronas Twin Towers.



Putrajaya Tour (Half-day)

A must see tour for all who visit Kuala Lumpur. Putrajaya is the new Administrative Centre of the Federal Government. This is a modern city with magnificent buildings. The highlights of the visit include the Prime Minister's Official Residence, Putrajaya Floating Mosque, Prime Minister Office, Putrajaya Square and Melawati Palace.



Karyaneka Handicraft Centre / Royal Selangor Pewter (Half-day)

Karyaneka, the national handicraft centre has a wide collection of handicraft reflecting Malaysia's ethnic and cultural heritage. The Royal Selangor Pewter produces a variety of pewter ware made from tin, copper and antimony. The famous Royal Selangor Pewter, hand-made to its perfection are known worldwide. The factory has over 700 skilled craftsmen producing pewter products ranging from cutlery, jugs souvenirs, goblets and many more

- ***Kuala Gandah Elephant Conservation Centre (Full day)***



Get up close and personal with the amazing semi-wild elephants at this elephant sanctuary located some two-hour drive away from Kuala Lumpur. The journey to this sanctuary is as scenic as the conservation centre itself with the dual carriage expressway meandering across the tropical highlands. The centre, established under the Department of Wildlife and National parks, is only one of its kind in the country. The centre is dedicated to locating, subduing and relocating problematic wild elephants from areas where their habitats are being encroached by development. Over the past 30

years, the centre has helped to resolve human-elephant conflicts and minimised the economic losses caused by such conflicts by relocating more than 700 wild elephants. In addition to being the home to the translocation team and a herd of trained resident elephants tasked with the relocation exercise, the centre also looks after orphaned elephants.

Accommodation

There are numerous hotels with various star ratings within the vicinity of Sunway Pyramid Convention Centre (SPCC), the conference venue. Delegates wishing to stay in the following hotels closest to the conference venue are requested to communicate **directly** with the hotels for their requirements. Special rates have been negotiated with the first three hotels*, and further information will be published in the final announcement.



| Hotel | Telephone | Website |
|---|----------------|---------------------------------------|
| Sunway Resort Hotel & Spa* (directly linked to SPCC) | +603-7492 8000 | kualalumpur.sunwayhotels.com |
| Sunway Pyramid Hotel* (directly linked to SPCC) | +603-7492 8000 | kualalumpur.sunwayhotels.com |
| Sunway Clio Hotel* (Within walking distance) | +603-7492 8000 | kualalumpur.sunwayhotels.com |
| Dorsett Grand Subang | +603-5031 6060 | www.dorsetthotels.com/malaysia/subang |
| Summit Hotel Subang USJ | +603-8023 3000 | www.summithotelusj.com |